

A

| Pos.     | Name                    | Part nr.      | Quantity |     |     |     |
|----------|-------------------------|---------------|----------|-----|-----|-----|
|          |                         |               | 130      | 160 | 190 | 225 |
| <b>A</b> | <b>FLAIL MOWER SIDE</b> | <b>nnnn</b>   |          |     |     |     |
|          | FRAME 130               | <b>019063</b> | 1        |     |     |     |
|          | FRAME 160               | <b>019164</b> |          | 1   |     |     |
|          | FRAME 190               | <b>019165</b> |          |     | 1   |     |
|          | FRAME 225               | <b>019166</b> |          |     |     | 1   |
| 3a       | ROTOR 130 H Cpl         | <b>017456</b> | 1        |     |     |     |
|          | ROTOR 130 Y-BL Cpl      | <b>017457</b> | 1        |     |     |     |
|          | ROTOR 160 H Cpl         | <b>017458</b> |          | 1   |     |     |
|          | ROTOR 160 Y-BL.Cpl      | <b>017459</b> |          | 1   |     |     |
|          | ROTOR 190 H Cpl         | <b>017368</b> |          |     | 1   |     |
|          | ROTOR 190 Y-BL Cpl      | <b>017369</b> |          |     | 1   |     |
|          | ROTOR 225 H Cpl         | <b>017370</b> |          |     |     | 1   |
|          | ROTOR 225 Y-BL Cpl      | <b>017371</b> |          |     |     | 1   |
| 4        | GEARBOX R-240           | <b>017943</b> | 1        | 1   | 1   | 1   |
| 4a       | PTO SHAFT SHIELD PVC    | <b>011880</b> | 1        | 1   | 1   | 1   |
| 4b 1     | UNDERLAYING PLATE R     | <b>017855</b> | 1        | 1   | 1   | 1   |
| 4c       | PIN T1 10x 8x 50        | <b>019181</b> | 1        | 1   | 1   | 1   |
| 4d       | BUSHING                 | <b>010139</b> | 1        | 1   | 1   | 1   |
| 4e       | WASHER fi 40/fi 15x8    | <b>010140</b> | 1        | 1   | 1   | 1   |
| 4f       | GEARBOX FLANGE          | <b>017850</b> | 1        | 1   | 1   | 1   |
|          | REAR ROLLER 130         | <b>110007</b> | 1        |     |     |     |
|          | REAR ROLLER 160         | <b>011733</b> |          | 1   |     |     |
|          | REAR ROLLER 190         | <b>011734</b> |          |     | 1   |     |
|          | REAR ROLLER 225         | <b>011735</b> |          |     |     | 1   |
| 5a       | ROLLER BRACKET R        | <b>010848</b> | 1        | 1   | 1   | 1   |
| 5b       | ROLLER BRACKET L        | <b>011699</b> | 1        | 1   | 1   | 1   |
|          | SCRAPER 130             | <b>010741</b> | 1        |     |     |     |
|          | SCRAPER 160             | <b>010742</b> |          | 1   |     |     |
|          | SCRAPER 190             | <b>010743</b> |          |     | 1   |     |
|          | SCRAPER 225             | <b>010744</b> |          |     |     | 1   |
|          |                         |               |          |     |     |     |
|          |                         |               |          |     |     |     |
|          |                         |               |          |     |     |     |
|          |                         |               |          |     |     |     |
|          |                         |               |          |     |     |     |
|          |                         |               |          |     |     |     |
|          |                         |               |          |     |     |     |
|          |                         |               |          |     |     |     |

A

| Pos.     | Name                    | Part nr. | Quantity |     |     |     |
|----------|-------------------------|----------|----------|-----|-----|-----|
|          |                         |          | 130      | 160 | 190 | 225 |
| <b>A</b> | <b>FLAIL MOWER SIDE</b> |          |          |     |     |     |
| 6        | BEARING WITH CASING     | 011927   | 2        | 2   | 2   | 2   |
|          | FLAP BAR 130            | 010747   | 1        |     |     |     |
|          | FLAP BAR 160            | 010748   |          | 1   |     |     |
|          | FLAP BAR 190            | 010749   |          |     | 1   |     |
|          | FLAP BAR 225            | 011013   |          |     |     | 1   |
| 8        | BELT SHIELD             | 010973   | 1        | 1   | 1   | 1   |
| 11       | BEARING CASING L        | 010753   | 1        | 1   | 1   | 1   |
| 12       | BEARING CASING R        | 010754   | 1        | 1   | 1   | 1   |
| 13       | PULLEY 130/80-3         | 011912   | 1        | 1   |     |     |
|          | PULLEY 130/80-4         | 011848   |          |     | 1   | 1   |
| 14       | TAPER LOCK ELVE 80/45   | 010760   | 2        | 2   | 2   | 2   |
| 15       | PULLEY 180/80-3         | 011915   | 1        | 1   |     |     |
|          | PULLEY 180/80-4         | 010757   |          |     | 1   | 1   |
| 17       | SKID L                  | 010013   | 1        | 1   | 1   | 1   |
| 17a      | SKID R                  | 010959   | 1        | 1   | 1   | 1   |
| 19       | OIL WASHER 45x90x10     | 012241   | 1        | 1   | 1   | 1   |
| 25       | FLAP 140                | 010769   |          | 2   | 5   | 12  |
|          | FLAP 130                | 110008   | 9        | 9   | 9   | 9   |
|          | FLAP 125                | 110009   |          |     |     |     |
| 25a      | FLAP 130-SPEC           | 010572   | 1        | 1   |     |     |
| 26       | Y-BLADE OPTION          | 010867   | 32       | 40  | 48  | 56  |
| 26a      | HAMMER                  | 011806   | 16       | 20  | 24  | 28  |
| 27       | BLADE SLEEVE            | 012462   | 16       | 20  | 24  | 28  |
| 28       | SPACER                  | 010771   | 64       | 80  | 96  | 112 |
| 29       | BELT                    | 010447   | 3        | 3   | 4   | 4   |
| 30       | BEARING                 | 011054   | 2        | 2   | 2   | 2   |
| 31       | SLIDE PC EXT 45         | 010404   | 2        | 2   | 2   | 2   |
| 32       | SLIDE PC INT. 100       | 010417   | 1        | 1   | 1   | 1   |
| 34       | BEARING CAP             | 010934   | 1        | 1   | 1   | 1   |
| 35       | BEARING CAP             | 010935   | 1        | 1   | 1   | 1   |
| 36       | BOLT M 10x 30           | 010259   | 1        | 1   | 1   | 1   |
| 37       | BOLT M 10x 16           | 012025   | 4        | 4   | 4   | 4   |
| 38       | BOLT M 14x 40           | 011835   | 4        | 4   | 4   | 4   |
| 39       | BOLT M 10x 35           | 010260   | 4        | 4   | 4   | 4   |
| 40       | BOLT M 12x 30           | 010998   | 4        | 4   | 4   | 4   |
| 40a      | BOLT M 12x 35           | 010270   | 1        | 1   | 1   | 1   |

A

| Pos.     | Name                    | Part nr.      | Quantity |     |     |     |
|----------|-------------------------|---------------|----------|-----|-----|-----|
|          |                         |               | 130      | 160 | 190 | 225 |
| <b>A</b> | <b>FLAIL MOWER SIDE</b> |               |          |     |     |     |
| 40b      | BOLT M 10x 25           | <b>012026</b> | 2        | 2   | 2   | 2   |
| 41       | BOLT M 14x 65           | <b>011843</b> | 1        | 1   | 1   | 1   |
| 42       | BOLT M 14x 35           | <b>010325</b> | 16       | 16  | 16  | 16  |
| 43       | BOLT M 14x 90           | <b>017322</b> | 16       | 20  | 24  | 28  |
| 44       | BOLT M 16x 80           | <b>012446</b> | 1        | 1   | 1   | 1   |
| 45       | LOCKNUT M14             | <b>010204</b> | 32       | 36  | 40  | 44  |
| 46       | LOCKNUT M10             | <b>010202</b> | 6        | 6   | 6   | 6   |
| 47       | NUT M14                 | <b>010191</b> | 4        | 4   | 4   | 4   |
| 48       | LOCKNUT M12             | <b>010203</b> | 2        | 2   | 2   | 2   |
| 49       | NUT M16                 | <b>010193</b> | 1        | 1   | 1   | 1   |
| 50       | WASHER 10               | <b>010219</b> | 3        | 3   | 3   | 3   |
| 51       | WASHER 10               | <b>010219</b> | 4        | 4   | 4   | 4   |
| 52       | WASHER 14               | <b>010221</b> | 21       | 21  | 21  | 21  |
| 53       | WASHER 12               | <b>010220</b> | 3        | 3   | 3   | 3   |
| 54       | SPRING WASHER 10        | <b>010232</b> | 3        | 3   | 3   | 3   |
| 56       | SPRING WASHER 14        | <b>010234</b> | 5        | 5   | 5   | 5   |
| 57       | SPRING WASHER 12        | <b>010233</b> | 5        | 5   | 5   | 5   |
| 59       | SPLIT PIN 3,2x30        | <b>010449</b> | 1        | 1   | 1   | 1   |
| 69       | GREASE NIPPLE AM 10x1   | <b>010395</b> | 2        | 2   | 2   | 2   |

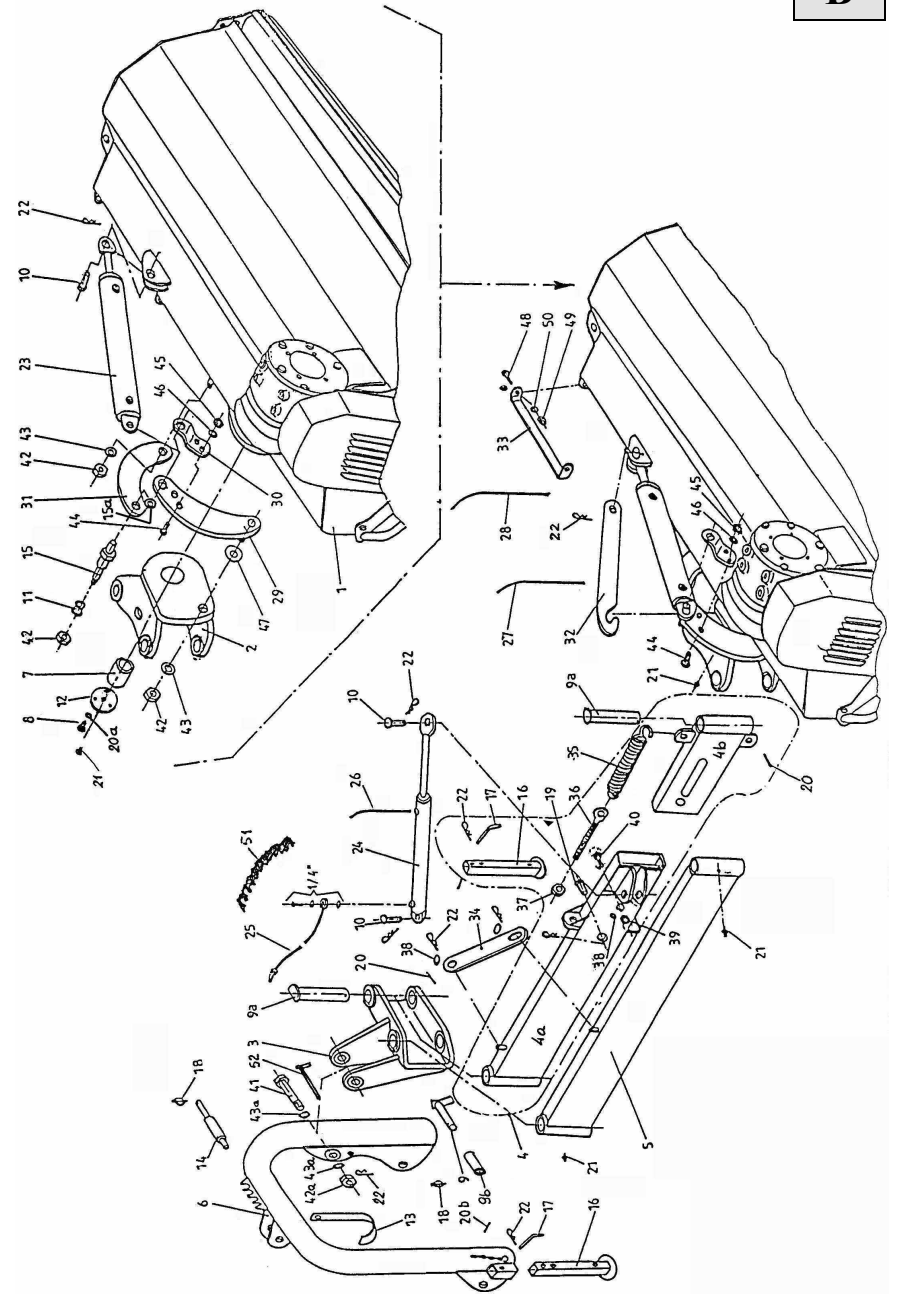

| Pos.     | Name                    | Part nr | Quantity |     |     |     |
|----------|-------------------------|---------|----------|-----|-----|-----|
|          |                         |         | 130      | 160 | 190 | 225 |
| <b>A</b> | <b>FLAIL MOWER SIDE</b> |         |          |     |     |     |
| 1        | FLAIL MOWER HEAD H      | 016593  | 1        |     |     |     |
| 1        | FLAIL MOWER HEAD Y      | 016594  | 1        |     |     |     |
| 1        | FLAIL MOWER HEAD H      | 016595  |          | 1   |     |     |
| 1        | FLAIL MOWER HEAD Y      | 016596  |          | 1   |     |     |
| 1        | FLAIL MOWER HEAD H      | 016597  |          |     | 1   |     |
| 1        | FLAIL MOWER HEAD Y      | 016598  |          |     | 1   |     |
| 1        | FLAIL MOWER HEAD H      | 016599  |          |     |     | 1   |
| 1        | FLAIL MOWER HEAD Y      | 016600  |          |     |     | 1   |
| 2        | CONNECT 1               | 018784  | 1        | 1   | 1   | 1   |
| 3        | CONNECT 2 115-160       | 016540  | 1        | 1   |     |     |
| 3        | CONNECT 2 190-225       | 016656  |          |     | 1   | 1   |
| 4        | ARM RIGHT CPL           | 016533  | 1        | 1   | 1   | 1   |
| 4a       | ARM RIGHT               | 016576  | 1        | 1   | 1   | 1   |
| 4b       | INNER ARM RIGHT         | 016541  | 1        | 1   | 1   | 1   |
| 5        | ARM LEFT                | 016548  | 1        | 1   | 1   | 1   |
| 6        | LINKAGE 115-160         | 016549  | 1        | 1   |     |     |
| 6        | LINKAGE 190-225         | 016613  |          |     | 1   | 1   |
| 7        | BUSHING fi 76/fi 68-70  | 017864  | 1        | 1   | 1   | 1   |
| 8        | BOLT M12x 25            | 010997  | 3        | 3   | 3   | 3   |
| 9        | PIVOT PIN fi 28         | 016648  | 2        | 2   | 2   | 2   |
| 9a       | PIN fi 30x240           | 010142  | 4        | 4   | 4   | 4   |
| 9aa      | WASHER 30               | 010227  | 4        | 4   | 4   | 4   |
| 9ab      | NUT M 30                | 017993  | 4        | 4   | 4   | 4   |
| 9b       | BUSHING fi 37/fi 28     | 018114  |          |     | 1   | 1   |
| 10       | PIN fi 20x55            | 010033  | 3        | 3   | 3   | 3   |
| 11       | BUSHING fi 40 x 23      | 016016  | 1        | 1   | 1   | 1   |
| 12       | WASHER 100              | 017932  | 1        | 1   | 1   | 1   |
| 13       | HOOK FOR PTO SHAFT      | 019024  | 1        | 1   | 1   | 1   |
| 14       | PIVOT PIN CONNECT19/25  | 010991  | 1        | 1   | 1   | 1   |
| 15       | PIN 36 x 135            | 015894  | 1        | 1   | 1   | 1   |
| 16       | SUPPORT FOOT            | 110036  | 2        | 2   | 2   | 2   |
| 17       | PIN fi 8                | 011598  | 2        | 2   | 2   | 2   |
| 18       | PIN fi 10               | 011618  | 3        | 3   | 3   | 3   |
| 19       | PIN fi 20x78            | 016577  | 1        | 1   | 1   | 1   |
| 20       | PIN                     | 010332  | 4        | 4   | 4   | 4   |
| 20a      | SPRING WASHER 12        | 019021  | 3        | 3   | 3   | 3   |
| 20b      | BOLT M 8 X 16           | 012024  | 2        | 2   | 2   | 2   |
| 20b      | LOCKNUT M8              | 010201  | 2        | 2   | 2   | 2   |
| 21       | GREASE NIPPLE AM8x1     | 011669  | 6        | 6   | 6   | 6   |

| Poz . | Naziv                 | Šifra  | Količina |     |     |     |
|-------|-----------------------|--------|----------|-----|-----|-----|
|       |                       |        | 130      | 160 | 190 | 225 |
| 22    | PIN R3                | 010327 | 10       | 10  | 10  | 10  |
| 23    | HYDR.CYLINDER 115-160 | 016120 | 1        | 1   |     |     |
| 23    | HYDR.CYLINDER 190     | 016572 |          |     | 1   |     |
| 23    | HYDR.CYLINDER 225     | 016738 |          |     |     | 1   |
| 24    | HYDR.CYLINDER 115-160 | 010285 | 1        | 1   |     |     |
| 24    | HYDR.CYLINDER 190-225 | 016574 |          |     | 1   | 1   |
| 25    | HYDRAULIC PIPE 1/4"   | 016825 | 1        | 1   | 1   | 1   |
| 26    | HYDRAULIC PIPE 1/4"   | 016826 | 1        | 1   | 1   | 1   |
| 27    | HYDRAULIC PIPE 1/4"   | 016827 | 1        | 1   | 1   | 1   |
| 28    | HYDRAULIC PIPE 1/4"   | 016828 | 1        | 1   | 1   | 1   |
| 29    | BRACKET L WITH PIN    | 018781 | 1        | 1   | 1   | 1   |
| 30    | BRACKET L             | 016589 | 1        | 1   | 1   | 1   |
| 31    | BRACKET R             | 015893 | 1        | 1   | 1   | 1   |
| 32    | HORISONT. BLOCKADE    | 019002 | 1        | 1   |     |     |
| 32    | VERTICAL BLOCKADE     | 016814 |          |     | 1   | 1   |
| 33    | FRAME GUARD           | 016559 | 1        | 1   | 1   | 1   |
| 34    | BLOCKADE              | 016560 | 1        | 1   | 1   | 1   |
| 35    | SPRING                | 016047 | 2        | 2   | 2   | 2   |
| 36    | BOLT M16x160          | 016044 | 2        | 2   | 2   | 2   |
| 37    | LOCK NUT M 16         | 010205 | 2        | 2   | 2   | 2   |
| 38    | WASHER 20             | 010224 | 5        | 5   | 5   | 5   |
| 39    | LOCK NUT M 20         | 010207 | 2        | 2   | 2   | 2   |
| 40    | BOLT M 20 x 80        | 011868 | 2        | 2   | 2   | 2   |
| 41    | BOLT M 30 x 180       | 017992 | 1        | 1   |     |     |
| 41    | BOLT M 30 x 190       | 017991 |          |     | 1   | 1   |
| 42    | LOCK NUT M 24         | 011810 | 3        | 3   | 3   | 3   |
| 42a   | LOCK NUT M 30         | 017993 | 1        | 1   | 1   | 1   |
| 43    | WASHER 24             | 010226 | 3        | 3   | 3   | 3   |
| 43a   | WASHER 30             | 010227 | 2        | 2   | 2   | 2   |
| 44    | BOLT M 14 x 55        | 016615 | 2        | 2   | 2   | 2   |
| 45    | LOCK NUT M 14         | 010204 | 2        | 2   | 2   | 2   |
| 46    | WASHER 14             | 010221 | 2        | 2   | 2   | 2   |
| 47    | WASHER 55 / 24x2      | 016603 | 1        | 1   | 1   | 1   |
| 48    | BOLT DIN 14 x 40      | 011835 | 2        | 2   | 2   | 2   |
| 49    | LOCK NUT M 14         | 010204 | 2        | 2   | 2   | 2   |
| 50    | WASHER 14             | 010221 | 2        | 2   | 2   | 2   |
| 51    | GUARD SPIRAL 25x30    | 016829 | 2        | 2   | 2   | 2   |
| 52    | PIN ř 14x155          | 017105 | 1        | 1   | 1   | 1   |